



BANYAN TREE KUALA LUMPUR

MEETINGS & EVENTS









Located in the heart of the nation's vibrant business capital and a quick 45-minute drive from the Kuala Lumpur International Airport, Banyan Tree Kuala Lumpur provides business guests with state-of the art event spaces set against a stunning cityscape for professional business meetings as well as intimate get togethers. With two 45 square metre boardrooms and a 90 square metre Signature Boardroom to choose from, our experienced event planners will ensure that your function is a resounding success.

Take advantage of our wide selection of soothing spa treatments for a refreshing pick-me-up in between business meetings or a wind down after the day's events.

At A Glance

1938 Sqft/ 180 Sqm Total Meeting Space | Three Meeting Venues | Host up to 93 persons | 55 Rooms and Suites

MEETING VENUES

Venues	Area						
 Signature Boardroom	90 ^(sqm) 968.8 ^(sqft)	-	-	-	-	16	-
 Boardroom 1	45 ^(sqm) 484.4 ^(sqft)	-	-	-	-	12	-
 Boardroom 2	45 ^(sqm) 484.4 ^(sqft)	20	15	35	15	12	35
 Open-Air Pool Deck	234 ^(sqm) 2518.8 ^(sqft)	-	-	-	-	-	30

Floor Plans

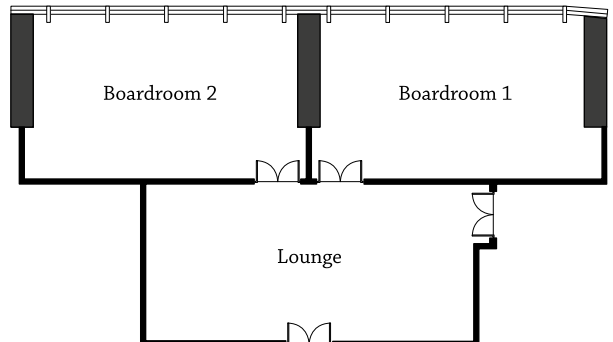
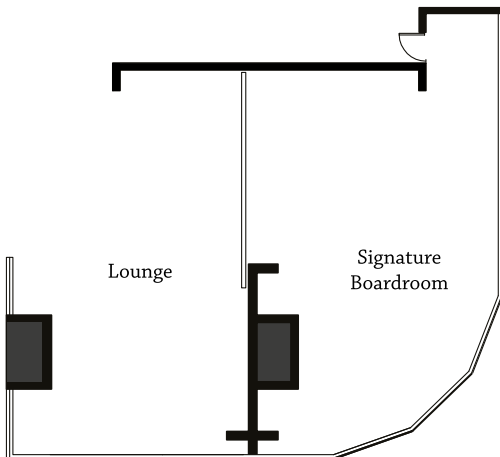

Location

Located in the heart of Kuala Lumpur, the capital of Malaysia, Banyan Tree Kuala Lumpur is a 45-minute drive from the Kuala Lumpur International Airport and accessible to key attractions and shopping areas in the city. Set in the cosmopolitan area of Kuala Lumpur, Banyan Tree Kuala Lumpur provides an idyllic haven, a tranquil ambience with charming views of the city skyline.

Accommodation

Standing tall and elegant at 60-storeys, Banyan Tree Kuala Lumpur offers 55 exquisite rooms and suites designed with contemporary flair. Refined and spacious, each of the seven room categories - from the Banyan Retreat room to the Banyan Tree Suite - is designed to bring comfort to those seeking a true Sanctuary for the Senses.

Room Type	Number of Units	Area (sqm)
Banyan Retreat	14	51-63
Signature Banyan Retreat	15	63-67
Signature Sky Retreat	18	54-67
Sky Suite	4	62
Sanctuary Suite	2	90
Sky Sanctuary Suite	1	116
Banyan Tree Suite	1	313
Signature Wellbeing Retreat	3	63

Facilities

Banyan Tree Kuala Lumpur provides a comprehensive suite of facilities to provide guests a holistic experience.

- Boardrooms – two spacious and fully equipped boardrooms readily available for those seeking to host intimate executive meetings or private engagements. Located at on Level 53, the exclusive boardrooms can accommodate up to 16 persons.
- Banyan Tree Spa – indulge and be pampered at the award-winning Banyan Tree Spa where all spa therapists undergo a minimum of 350 hours of training at the renowned Banyan Tree Spa Academy.
- Gym – excellently equipped with state-of-the-art fitness gear and changing rooms.
- Open Air Pool – offering a perfect view of the city skyline from Level 53, it is an ideal place to relax and unwind.

Dining

Enjoy a feast for the senses high above the city with a western dining venue, a rooftop bar, a wine lounge, a bakery and in-room dining service.

- Bake by Banyan Tree – located at the lobby, Bake by Banyan Tree offers a range of fine patisserie and artisan breads. It is the ideal place to savour a quiet bite and enjoy specialty beverages.
- Altitude – located on Level 53, Altitude offers a serene setting for morning coffee, light lunch, exquisite afternoon tea and sommelier's handpicked wines and craft beers, paired perfectly with a curated casual menu for a wonderful evening.
- Ebisu at Altitude – located on Level 53, this dining venue features a unique statement of fusion Japanese cuisine.
- Horizon Grill – an all-day dining venue offering hearty a la carte breakfast, executive lunch to epicurean dinner menu with succulent seafood and premium steaks. Located on Level 58, it comes with panoramic views of the iconic Petronas Twin Towers and Kuala Lumpur Tower.
- Vertigo – a rooftop bar located on Level 59 offering breathtaking views of the city skyline.
- Vertigo Too – the highest, open-air events space with flexible set-up options and unobstructed views of the Klang Valley.

Activities

With Banyan Tree Kuala Lumpur perfectly situated in the heart of the “Golden Triangle”, Kuala Lumpur’s commercial, shopping and entertainment hub, guests can enjoy direct access to Pavilion Kuala Lumpur via a private connecting bridge and a number of major streets including Bukit Bintang where they can shop for hours, or experience the nightlife and entertainment. A short walk away, world-renowned landmarks such as Kuala Lumpur Tower, Petronas Twin Towers and Kuala Lumpur Convention Centre await to be explored.