



China

BANYAN TREE
Lijiang



Make your business flourish in these ancient and stunning surroundings

Bring your business to our Lijiang meeting venues to set the scene for something special. Use the historic setting as an opportunity to bring the future into your business, while remembering the past.

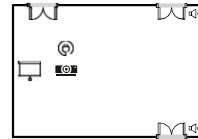
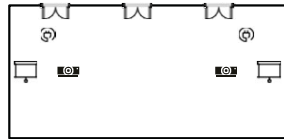
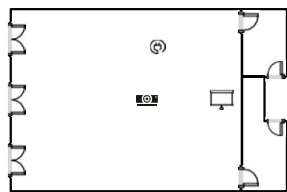

Jade Dragon Grand Ballroom



Jade Water



Black Dragon

Banyan Tree Lijiang

Yuerong Road, Shuhe, Gucheng District, Lijiang, P. R. China 674100

Tel: +86 888 533 1111
Fax: +86 888 5336666
lijiang@banyantree.com



Jade Dragon Grand Ballroom	326 sqm 3381 sqft	160	120	240	52	•	260	•
Jade Water	144 sqm 1540 sqft	80	90	120	46	50	150	•
Black Dragon	108 sqm 1155 sqft	40	40	60	30	20	80	•
Jade Water 1	40 sqm	•	18	40	•	15	•	•
Jade Water 2	40 sqm	•	18	40	•	15	•	•
Jade Water 3	40 sqm	•	18	40	•	15	•	•

At a Glance

7653 sqft / 711 sqm Total Space • Three Meeting Venues • 260 Persons • 42 Suites + 81 Villas

Room Type

Garden View Suite (21) • Mountain View Suites (21) • Jet Pool Villa (20) • Wellbeing Jet Pool Villa(20) • Plunge Pool Villa (13) • Two-bedroom Mountain View Duplex(16) • Two-bedroom Mountain View Jet Pool Villa (1) • Three-bedroom Mountain View Jet Pool Villa(1) • Three-bedroom Mountain View Pool Villa • Presidential Suite(1)

Destination

Historical town of Dayan • Jade Dragon Snow Mountain • Lashi Lake • Tiger Leaping Gorge • Old Town of Lijiang (UNESCO World Heritage Site)

Amenities

- Meeting Features**
 - Five Meeting Rooms • Internet Access • Audio-Visual Equipment • Breakout Rooms • Dedicated Meeting Planners
- Hotel Facilities**
 - Fitness Centre • Library and Games Room • Spa • Gallery
- Restaurants**
 - Ming Yue • Bai Yun • Wen Hai Bar • In-Villa Dining