

China

BANYAN TREE

Tianjin Riverside

A city made for meetings and events

Tianjin is an important commercial centre, and a great place to host your meetings or corporate events.

With the Banyan tree retreat as your base, you will feel inspired and efficient in your business dealings

Banyan Tree Tianjin Riverside

No. 34 Haihe East Road,
Hebei District, Tianjin P. R. China

Tel: +86 22 5861 9999

Fax: +86 22 5861 9998

GS-TianJin@banyantree.com



Banyan Ballroom	540 sqm 5813 sqft	240	200	380	100	120	240	.
Beian Meeting Room	62 sqm 667 sqft	20	18	40	16	12	.	.
Haihe Ballroom	280 sqm 3014 sqft	120	120	220	60	60	200	.
Jintang Meeting Room	24 sqm 258 sqft	6	.	.
Jinbu Meeting Room	42 sqm 452 sqft	12	.	.

At a Glance

9526 sqft / 885 sqm Total Space • Three Meeting Venues • 420 Persons • 153 Rooms and Suites

Room Type

Executive Retreat (39) • Deluxe Riverside Retreat (28) • Premier Riverside Retreat (60) • Riverside Suite (12) • Premier Suite (13) • Banyan Tree Suite (1)

Amenities

Meeting Features

Five Meeting Rooms • Internet Access • Business Centre • Audio-Visual Equipment • Dedicated Meeting Planners

Hotel Facilities

Spa • Fitness Centre • Swimming Pool • Gallery

Restaurants

River Café • Bai Yun • Lobby Lounge

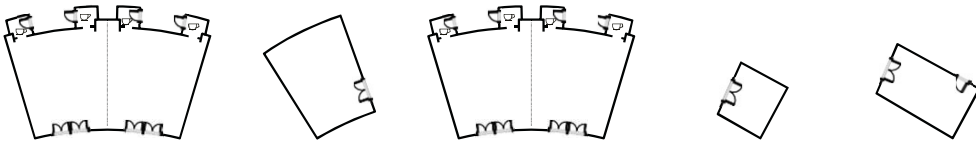

Banyan Ballroom



Beian Meeting Room



Haihe Ballroom



Jintang Meeting Room



Jinbu Meeting Room